

# D120P1

## LED ROUND KST

○ WITH ROUND LIGHT PATTERN

### Underwater spotlight

Classic, round and stylish: the housing of the LED round KST is made of polycarbonate and is solidly CNC-machined. Completely without exposed metal parts.

Easy assembly and latest RGBW multichip LEDs with integrated chip in daylight white provide seamless color changes and a clear white. The LEDs have been arranged in a circular pattern. Thoughtful design for a harmonious luminous image.



### Specifications

- Installation opening: D=120 mm
- Installation depth: 50 mm
- Polycarbonate housing
- No exposed metal parts
- Brine and salt water resistant
- Total power RGBW ON 27/55 Watt
- Round light pattern
- With dedicated white in 4500K (daylight)
- Illumination angle approx. 160°

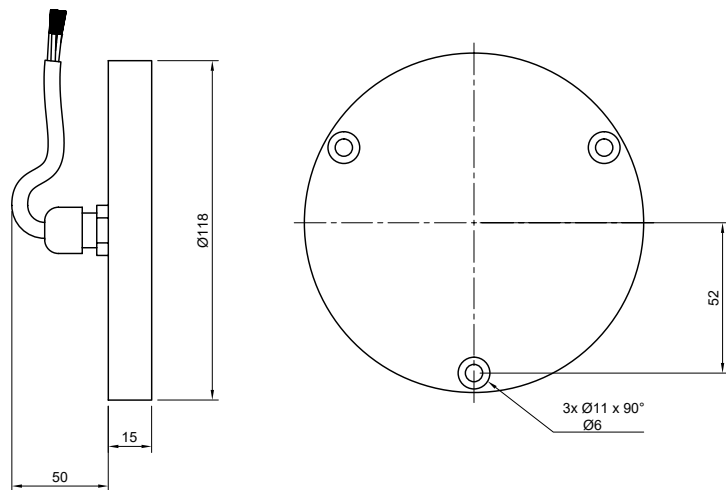

### Standard

- System voltage 24VDC
- Constant current 350/700mA
- RGBW: color change with separate daylight white in 4500K
- 15m PUR cable
- Brine resistant design

### Customized

- Custom branding
- Cable length
- Installation niche

### Accessories

- DMX Ctrl or CC Box

